

QUEEN MARY'S GARDENS

· TOWN OF HAMPSTEAD · ISLAND OF MONTREAL ·
 · DEVELOPMENT · SCHEME ·
 · BLOCK · PLAN · SHOWING · LAYOUT · OF · GROUNDS ·

SCALE 1/32" = 1 FOOT

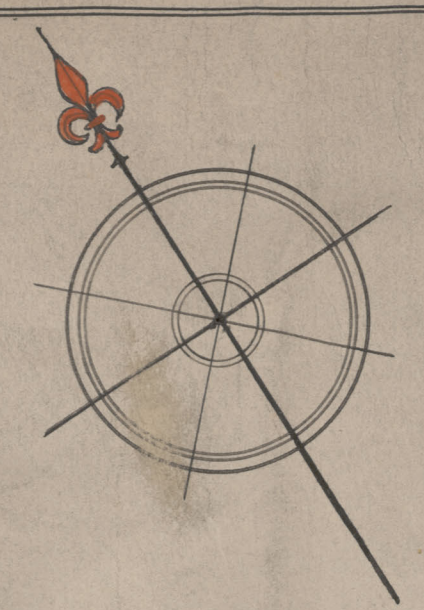
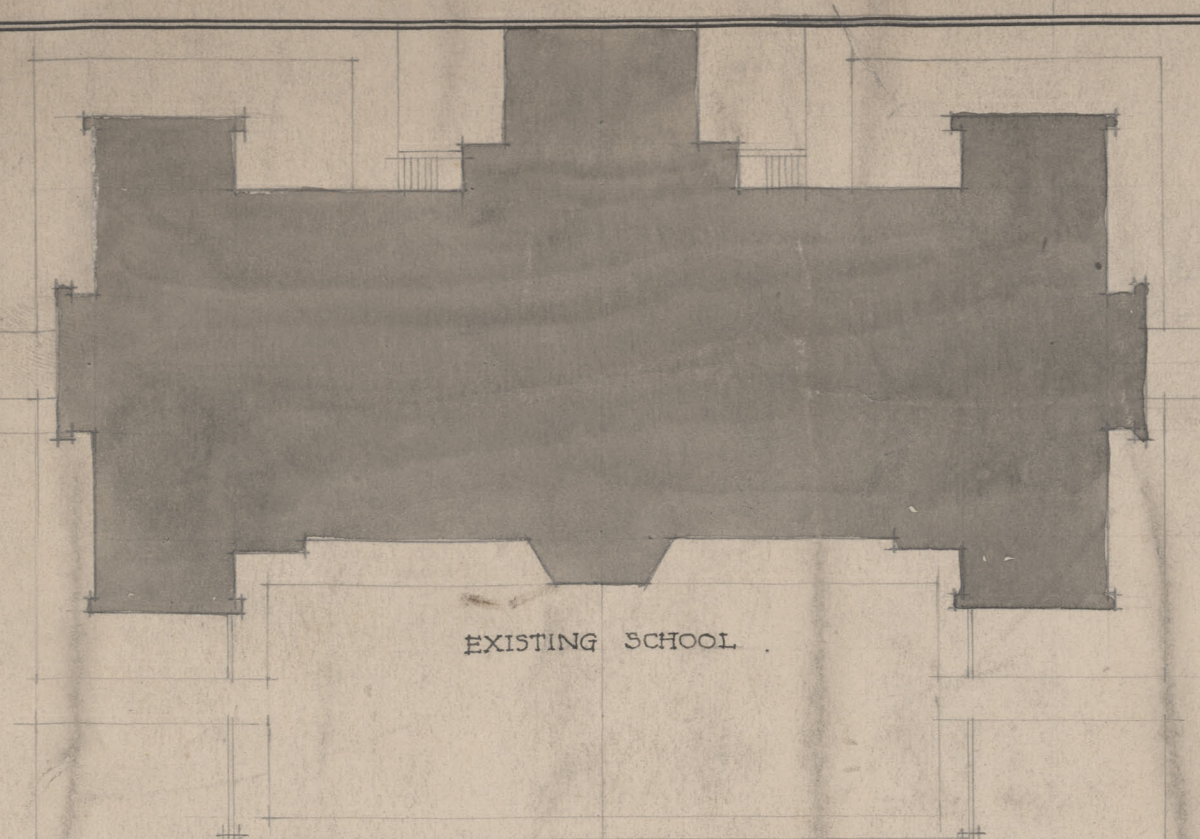

ADELAIDE ROAD

THURLOW ROAD

MERTON ROAD

ROAD

NORTHCOTE

QUEEN MARY ROAD



1	10	27	28
2	11	26	29
3	12	25	30
4	13	24	31
5	14	23	32
6	15	22	33
7	16	21	34
8	17	20	35
9	18	19	36

- PUBLICLY MAINTAINED GRASS TREES & SHRUBBERY
- HOUSES AND OTHER STRUCTURES WITH PITCHED ROOFS
- GARDENS AND BACK YARDS APPERTAINING TO HOUSES

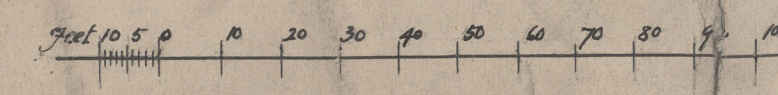

- TENNIS COURTS AND FLAT ROOFED STRUCTURES
- ROAD PAVING OF GENERAL YARD
- SIDEWALKS, PATHS AND LANES

1

NOBBS & HYDE
 ARCHITECTS
 14 PHILLIPS SQ.
 MONTREAL

17th NOV. 1925.



FRONTAGE ON THURLOW ROAD



QUEEN MARY'S GARDENS

TOWN OF HAMPSTEAD ISLAND OF MONTREAL

SCALE OF FEET. $\frac{1}{32}$ " = 1'-0"

ON MERTON ROAD

ON NORTHCOTE ROAD



FRONTAGE ON QUEEN MARY ROAD