

Dressed
mum & Plum
from light

[Faint handwritten notes, possibly a date or list of items]

[Faint handwritten notes, possibly a list of items]

[Faint handwritten notes, possibly a list of items]

[Faint handwritten notes, possibly a list of items]

[Faint handwritten notes, possibly a list of items]

McGILL UNIVERSITY
ARCHIVES
ACC. NO. 2211711
REF. 22

October 27th 1869 went to King John - Saw Esq
Devine Esq concerning the Claims which he and his
brothers were said to possess on a part of my
Thames lot of land, when he said in the pre-
sence of Mr Gould the Surveyor, that he
and his Brothers had held a conference on
the subject when they had come to the re-
solution of abandoning the Claims, and
they now recognised my Boundaries as ori-
ginally surveyed, to the satisfaction of Mr Thaine.

TA On the following day I proceeded in comp-
any with the following individuals to the land
to measure certain parts of the line which we
were not sure about and renew them.

John Gould, Surveyor, Julia McDonald & Mrs
Langill, Chainmen, Christopher and James Langill
Purchasers of the land we are at. Commenced
at a point on the North Boundary line where a

Tree is marked as a corner and chained
south along the Eastern Boundary line and
found it to be 50 chains good measure to S E corner
Tree (a) on 400 rods - The breadth
of this lot the Langills and I agreed should stand
at 23 chains or 92 rods, as found by Mr Gould at
a late measurement. Contents of this lot 115 acres,
the add^l 15 acres the Langills agreed to take at 10¢
per acre, to pay in one year after the 1st day of

paid without interest. We then commenced to
re-measure the line between my remaining lot & the
Shant 100/ and Daniel Leung's land on the South,
beginning at a Haulak Corner Tree, standing 30 chains
by actual measurement due South from the point
where we first commenced, we then proceeded
East tracing the Original marked line and re-
measuring it until we came to a corner tree
which we found lying on its side, having been
blown down by the wind; - This line we found
to be a full half over 32 chains by actual measurement
and the natural corner tree had the letters AT
visibly cut in on the side. Contents of this lot
96 acres - The land wherever seen it appears to
be of the very best quality, heavily timbered with
a fine mixture of trees, and gently declining
to the South East. we crossed two small brooks
which meander through it towards the River
Saw no appearance of Fire having been on it,

This Sketch Shows the Lay of the Leds to which our attention
 but is not Exact in its relative Lengths
 and Breadths for want of
 Space.

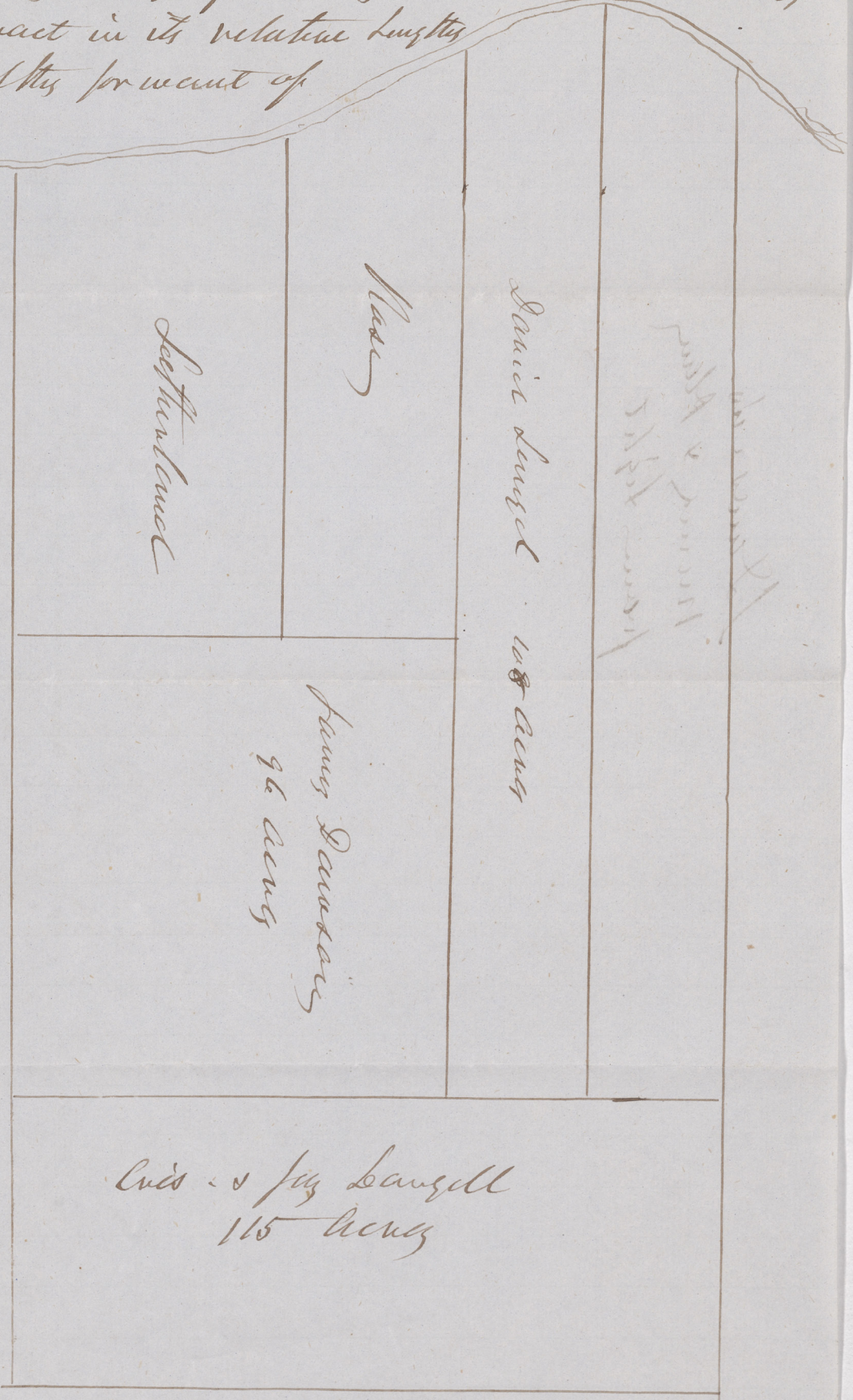

Soffit Lined

Leds - 115 Leds

McGILL UNIVERSITY
 ARCHIVES
 ACC. NO. 1371
 REF. 33