

PASSENGER DEPARTMENT.

TELEGRAPHIC ADDRESS: "MAC IVER." LIVERPOOL.

TELEPHONE No. 251.



"BEAVER" LINE OF PASSENGER STEAMERS,
WEEKLY SAILINGS,
LIVERPOOL to CANADA and the UNITED STATES.

D. & C. MAC IVER (Managers)

TOWER BUILDINGS, WATER STREET,

Liverpool, 10th June 1896

Sir William Dawson

Esq. Mr. H. J. Allen

40 Seel St

Liverpool.

Dear Sir

We have received instructions from Capt Stewart of the *Lake Superior* to reserve one of the spar deck rooms for the accommodation of yourself & Lady Dawson on the 22nd August. We regret however for some weeks prior to Capt Stewart's application all the spar deck rooms for that voyage were taken up. We enclose herewith a diagram of the *Lake Superior* Cabin showing the staterooms still disengaged & shall be glad to have your instructions to secure a berth at your convenience.

We understand from Capt Stewart that you wish to secure his room, & if so, instructions had better be given to us at once as there are sure to be numerous applications for this room before the day of sailing.

Yours Respectfully,

For the BEAVER LINE,

D. & C. Mac Iver

Managers.

PASSENGER DEPARTMENT
"BEAVER" LINE OF PASSENGER STEAMERS
WEEKLY SAILINGS
LIVERPOOL to CANADA and the UNITED STATES
D. & C. MAC IVER (Managers)



Tower Buildings, Water Street
Liverpool, 1886

X X X X
X X

Beaver Line
June 10 1896
Replied at Key
Reveries Captain
Leath, June 12/96

McGILL UNIVERSITY
ARCHIVES
ACC. NO. 1463
REF. 618

"BEAVER LINE" OF PASSENGER STEAMERS.

SALOON PLAN SS "LAKE ONTARIO" 5300 TONS

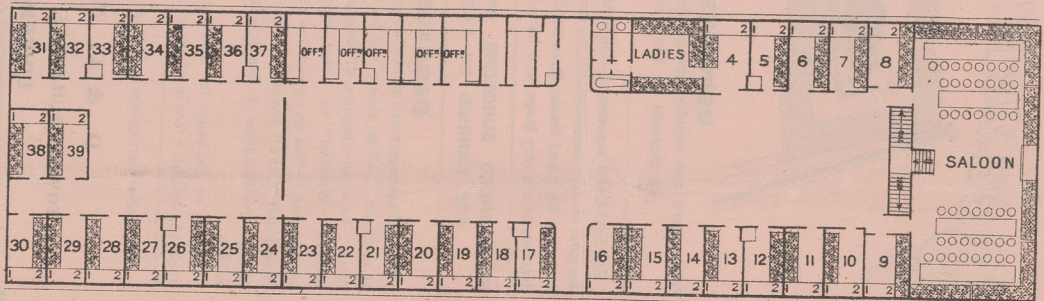

ODD NUMBERS ARE LOWER BERTHS.

SALOON PLAN SS "LAKE SUPERIOR" 5300 TONS

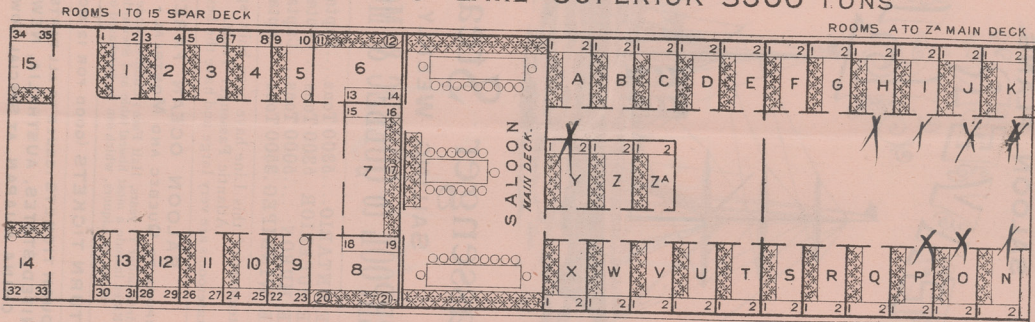

ODD NUMBERS ARE LOWER BERTHS.

*Rooms marked X are disengaged for the
Lake Superior route.*

SALOON PLAN S.S. LAKE HURON 5000 TONS.

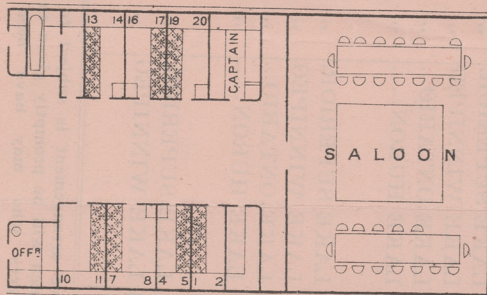

ODD NUMBERS ARE LOWER BERTHS.

SALOON PLAN S.S. LAKE WINNIPEG 3500 TONS

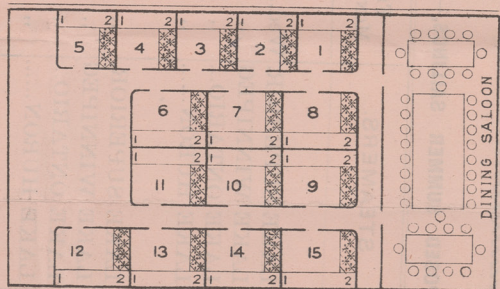

ODD NUMBERS ARE LOWER BERTHS.

MCGILL UNIVERSITY
ARCHIVES

ACC. NO. 1463

REF. 678A

TELEGRAPHIC ADDRESS: "MAC IVER, LIVERPOOL."

SALOON PLANS.

BEAVER LINE

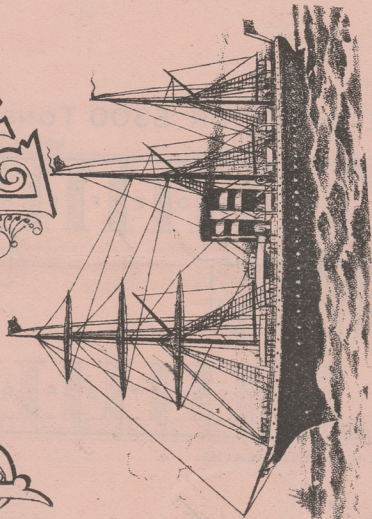

1896.—PROPOSED SUMMER SAILINGS,—1896.

FROM LIVERPOOL.	STEAMERS.	FROM MONTREAL.
Sat., June 13	LAKE SUPERIOR.	Wed., July 1
" " 20	LAKE WINNIPEG	" " 8
" " 27	LAKE ONTARIO...	" " 15
July 4	LAKE HURON	" " 22
" " 18	LAKE SUPERIOR.	Aug. 5
" " 25	LAKE WINNIPEG	" " 12
" Aug. 1	LAKE ONTARIO...	" " 19
" " 8	LAKE HURON	" " 26
" " 22	LAKE SUPERIOR.	Sept. 9
" " 29	LAKE WINNIPEG	" " 16
Sept. 5	LAKE ONTARIO...	" " 23
" " 12	LAKE HURON	" " 30
" " 26	LAKE SUPERIOR.	Oct. 14
" Oct. 3	LAKE WINNIPEG	" " 21
" " 10	LAKE ONTARIO...	" " 28
" " 17	LAKE HURON	Nov. 4
" " 31	LAKE SUPERIOR.	" " 18
Nov. 4	LAKE WINNIPEG	" " 25

The above arrangement is subject to change, notice of which will be promptly given to agents, and passengers who may have been booked accordingly.

"Beaver" Line

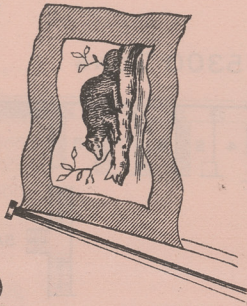

DEPOSITS

Passengers can secure Saloon Berths by payment of £5 deposit to the undersigned.

The SALOON accommodation is fitted throughout with all the most modern improvements for the comfort of Passengers. There are Bath and Smoke Rooms; also Ladies' Saloon. The Staterooms are very large, and have the best of ventilation.

EXPERIENCED SURGEONS AND STEWARDESSES ARE CARRIED BY EACH STEAMER.

BAGGAGE.

Cabin Passengers are allowed 30 cubic feet of Luggage free to each adult; all in excess will be charged for at moderate rates. To avoid mistakes, all Baggage should be distinctly marked "Wanted" or "Not Wanted." Labels for this purpose can be had on application at principal Agencies. It is desirable that all heavy packages be sent to the care of the Company with advice of despatch at least three days before sailing.

Trunks or Packages for Staterooms should not exceed 15 inches in height; 2 feet in width, or 3 feet 6 inches in length.

For further particulars and to secure berths, apply to

D. & C. MAC IVER.

TOWER BUILDINGS, WATER STREET,
LIVERPOOL.

Passenger Steamers

SAILING WEEKLY

LIVERPOOL to QUEBEC & MONTREAL

LAKE ONTARIO...5300 Tons...Captain Campbell.
LAKE SUPERIOR...5300 Tons...Captain Stewart.
LAKE HURON...5000 Tons...Captain Carey.
LAKE WINNIPEG...3900 Tons...Captain Fayrer.

The Steamers of this Line have been built specially for the Atlantic Passenger Trade. The Staterooms are very large and have the best of ventilation.

SALOON OCEAN FARES.
LIVERPOOL TO QUEBEC AND MONTREAL - - £10 10s.
Children under 12 years, Half Fare; Children under 2 years, Free.
These Rates include a most liberal table and Stewards' Fee, but without Wines or Liquors, which can be purchased on board.

RETURN TICKETS (GOOD FOR 12 MONTHS) £19

THROUGH TICKETS ISSUED TO ALL PARTS OF CANADA, UNITED STATES, AUSTRALIA, NEW ZEALAND, CHINA & JAPAN, AT SPECIAL LOW RATES.