

MAP OF THE CITY OF MONTREAL

INCLUDING CITIES OF WESTMOUNT, OUTREMONT, VERDUN, MAISONNEUVE AND MOUNT-ROYAL.
 Prepared Expressly for
LOVELL'S MONTREAL DIRECTORY
 For 1913-1914

COPYRIGHT, CANADA 1913
 BY **HAS E. GOAD CO.**
 CIVIL ENGINEERS

MONTREAL, TORONTO, WINNIPEG
 & VANCOUVER, CANADA.
 LONDON, ENGLAND.

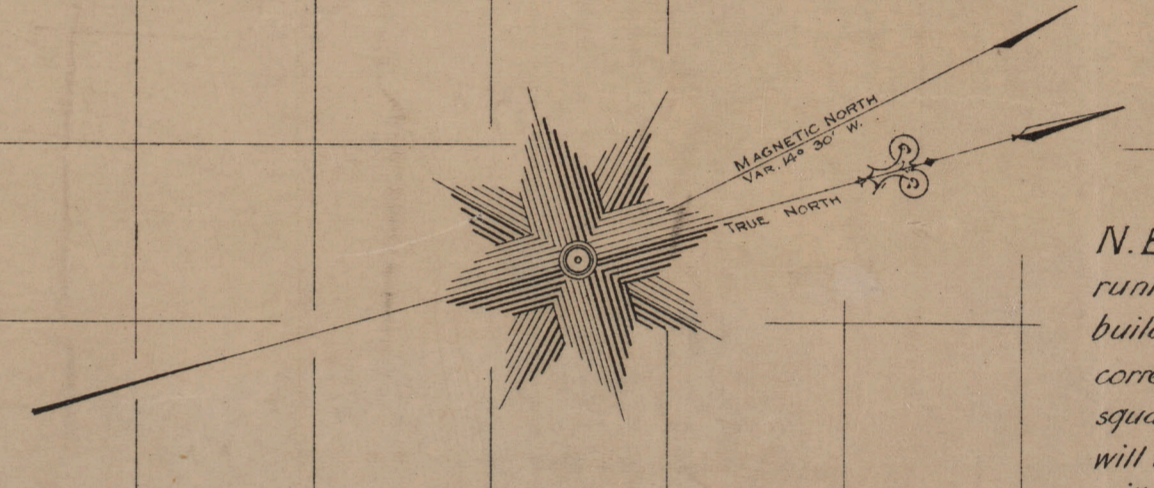

STREET INDEX
 N.B. The Map is divided into quarter mile squares by lines running North & South and East & West. To find a street or public building, note the letter and number against it in index, then find the corresponding letter and number in margin of Map and follow the square horizontally & vertically from them. The required street will be found in the square of intersection. Thus 47C & 12 is found in the square horizontally opposite 47 and vertically in line with 12.
 N.B. Montreal Street Railway shown thus: ————

INDEX TO STREETS

A	B	C	D	E	F	G	H	I	J	K	L	M	N	O	P	Q	R	S	T	U	V	W	X	Y	Z
Abbott St.	Abbott St.	Abbott St.	Abbott St.	Abbott St.	Abbott St.	Abbott St.	Abbott St.	Abbott St.	Abbott St.	Abbott St.	Abbott St.	Abbott St.	Abbott St.	Abbott St.	Abbott St.	Abbott St.	Abbott St.	Abbott St.	Abbott St.	Abbott St.	Abbott St.	Abbott St.	Abbott St.	Abbott St.	Abbott St.